

Braid in the Middle

Cutting Instructions

Main fabric - (4) $2\frac{1}{2}'' \times 17\frac{1}{2}''$, (8) $7\frac{1}{8}'' \times 2''$,
 (1) $4\frac{1}{2}'' \times 13\frac{1}{2}''$, (1) $1\frac{1}{4}''$ strip for binding,
 (8) handle tabs if needed using template
 provided.

Side contrast strips - (12) $7\frac{1}{8}'' \times 2''$

Sashing - (4) $7\frac{1}{8}'' \times 17\frac{1}{2}''$

Make (2) copies of braid foundation and foundation piece. Sew (6) $7\frac{1}{8}'' \times 2''$ together (Diagram 1). Repeat for total (4). Sew unit to each side of braid foundation unit (Diagram 2). Repeat for total (2). Sew contrast band to top and bottom (Diagram 3). Repeat for total (2). Sew $2\frac{1}{2}'' \times 17\frac{1}{2}''$ to top and bottom (Diagram 4). Repeat for total (2). Sew bag units together with $4\frac{1}{2}'' \times 13\frac{1}{2}''$ bottom print between (Diagram 5).

Layer bag front with batting and back and quilt. Trim back and batting edges even with bag. Zig zag or serge edges.

Fold bag in half right sides together and stitch side seams (Diagram 6). Refold and stitch bottom to sides (Diagram 7).

Bind top edge. With right sides together sew handle tabs together leaving an opening to turn. Turn, press, and stitch opening shut. Repeat for total (4) finished tabs. Use tabs to attach handles to bag. Stitch a button to each tab (Diagram 8).

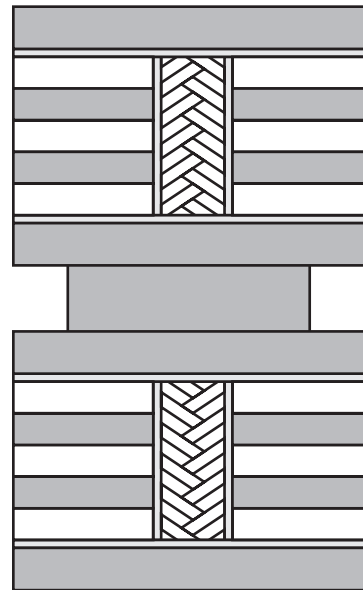

Diagram 5

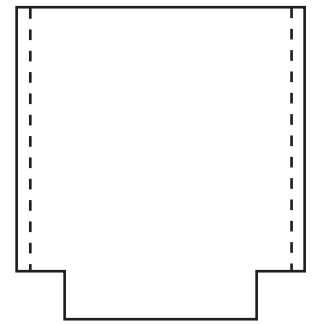

Diagram 6

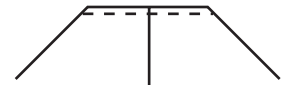

Diagram 7

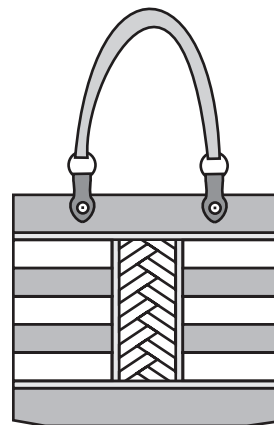

Diagram 8

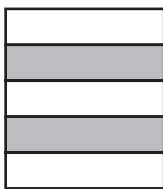
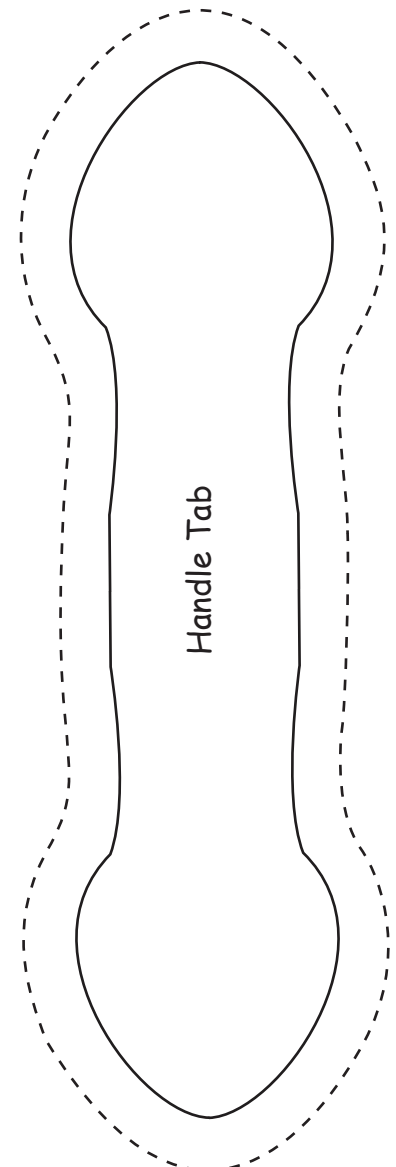

Diagram 1

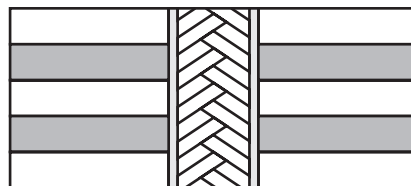

Diagram 2

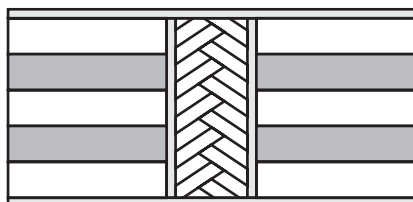

Diagram 3

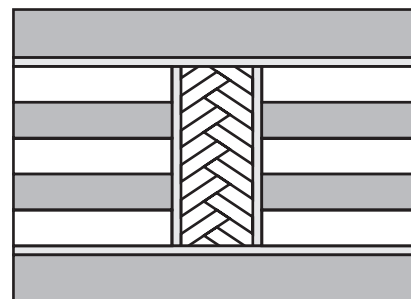
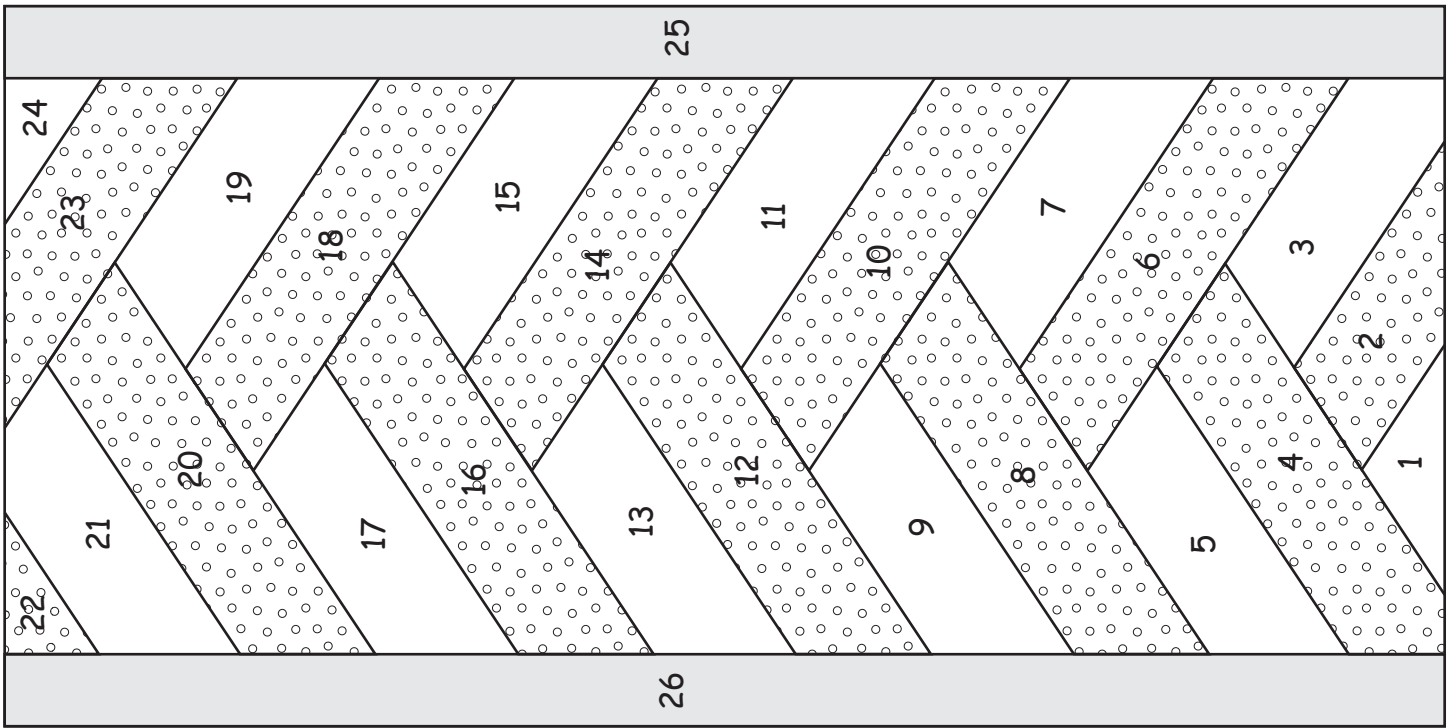

Diagram 4



Make 2 Copies

See all our designs by visiting us
on the web at:

www.scrapsoftimequilts.com
and
www.rgadesignquilts.com

Scrap of Time
2571 Longmeadow Dr.
West Jordan, UT 84084-5806
(801)964-1834
janet@scrapsoftimequilts.com

RGA Design
1141 Beecher Avenue
Brigham City, UT 84302
(435)723-7288
renae@rgadesignquilts.com



Braid in the Middle

